

(C) Copyright CANVASs Co., Ltd.

=====

【Software】 SST G1 Pro Update Installer

【Target Product】 SST G1Pro

【Registered Name】 SST G1 Pro Ver.3.1.24(English)

【Application Name】 setup.exe

【Copyright Holder】 CANVASs Co, Ltd.

【System Requirement】 Microsoft Windows 10/11 English version

【Distribution Terms】

1) Redistribution of downloaded files is strictly prohibited.

2) Reproduction in whole or in part in any form or medium is prohibited.

=====

<Ver.3.1.24> 2024.5

CONTENTS

1) New Features and Improvements

2) Fixed Bugs

3) Notes on inheriting settings such as shortcut key assignments after uninstallation and
Reinstallation

4) Please be sure to read this prior to update

1) New Features and Improvements

●Input Subtitle Text

- We have fixed an issue where even if you selected and overwrote texts in Subtitle Window, the texts would remain instead of being overwritten.

When you select characters and enter new characters in a subtitle window, the selected characters are supposed to be overwritten and erased. But in case the Japanese input system was set to Microsoft IME, an issue where the selected characters remained occurred. This is caused by a Microsoft IME defect introduced in Windows 10 version 20H2 and Windows 10 version 2004 updates. To resolve this issue, the specification of SSTG1Pro has been changed so that you can now overwrite correctly with Microsoft IME.

●Export IMSC1.1(TTML2) *Paid option

<Common matters among all Output Types>

- When you select [Output Type], the items displayed in [Styling Information] will now change accordingly.
- The check box of "Calculate as 23.976fps for 24P Project" on [Advanced] tab is now enabled only when 24P project is opened.

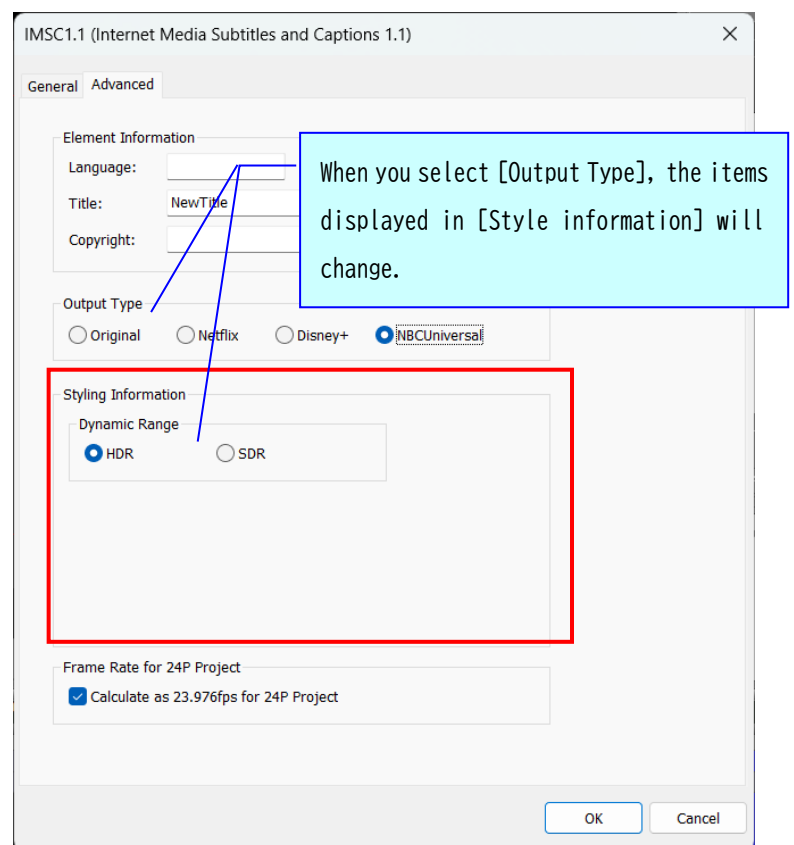

<Output Type: NBCUniversal only>

- In previous versions, it was only possible to output for HDR, but now it can also be output for SDR.
- Changed the output timing information from timecode to real-time.

In previous versions, timing information was output in timecode (frames). From the latest version, it is output in real-time.

NOTE: The digit next to the second is expressed in 10 milliseconds (2 digits).

Video Frame	10ms notation	Example
29.97fps	00~29	In case real-time is 00:00:01,852 -> → 00:00:01:25
25.00fps	00~24	In case real-time is 00:00:01,852 -> → 00:00:01:21
24.00fps	00~23	In case real-time is 00:00:01,852 -> → 00:00:01:20
23.976fps	00~23	In case real-time is 00:00:01,852 -> → 00:00:01:20

This 10 millisecond notation is changed to a two-digit 10 millisecond notation according to the video frame after converting to real time. Please note that this is different from the frame on SSTG1Pro.

- When exporting from 24Fr project, it is now always treated as 23.976fps.

2) Fixed Bugs

- We have fixed a problem where “_CST_Subtitle0000.sdb” (“0000” is a sequential number) was created in the folder where backup files are saved when you use “Copy with formats”.

●Export IMSC1.1(TTML2) *Paid Option

1) For Disney+

We have fixed a problem where the number of frames was counted as 29.97 when exporting from a 24Fr project.

2) For NBCUniversal

1. We have fixed a problem where all the out time in exported IMSC1.1 files are 1 frame longer than the out time set in SSTG1Pro.
2. We have fixed a problem where [Calculate as 23.976fps for 24P project] checkbox on the [Advanced] tab cannot be selected.

*These are fixes for the bugs we reported on December 20th.

3) Notes on inheriting settings such as shortcut key assignments after uninstallation and reinstallation

With Ver.3.1.2, we improved the software so that it can inherit customized settings such as user settings and shortcut key assignments when you reinstall the software after uninstallation. However, due to the function enhancement of Windows, we have found that these settings might be reset and returned to the initial state upon uninstallation.

To ensure that your settings are inherited after reinstallation, please follow the steps below:

※Normal updates that do not require manual uninstallation will not have any problems.

※This occurs regardless of the version. Please note that it might happen even if you are not using this version.

■If you are using Ver3.1.1 or later

Export your settings from the Shortcut Key Settings screen, reinstall the software, and then import the settings file from the Shortcut Key Settings screen again.

※Settings that have been saved in the list beforehand such as User Settings, Format Settings, Final Check Items Filter, Check Word of Final Check will not be lost.

■If you are using version older than 3.1.1

Export User Settings, Shortcut Key Settings from each screen, reinstall the software, and then import the settings file from the same screen you exported them.

※Settings that have been saved in the list beforehand such as Format, Check Word of Final Check will not be lost.

4) Please be sure to read this prior to update

※Please skip this section if you are using ver3.1.1 or above.

■About the message displayed while updating

When updating from Ver1.1.39 or lower, this procedure includes the uninstallation of SSTG1Pro which has been already installed.

When executing the updater (setup.exe), the message **“SSTG1Pro is installed. Are you sure to start uninstalling?”** will be displayed. Choose “Yes” and follow the procedure. It will complete the updating.

Your individual settings such as User Settings, Format and Shortcut Key Settings will be kept after this uninstallation.